

1967

SHELBY GT500

SUPER SNAKE

1:8 SCALE



Pack 09 | Build Instructions

Your Shelby GT500 Super Snake is a finely detailed model replicating every aspect of the original car. From the paint color to the smallest interior details, every piece is precisely reproduced.

In your ninth model pack, you will assemble:

**STAGE 65: FIRST PARTS OF
THE RADIATOR**

**STAGE 66: RADIATOR SHROUD
AND FAN BLADE**

STAGE 67: FRONT OF THE RADIATOR

STAGE 68: ENGINE PARTS

**STAGE 69: FRONT HOUSING AND
PRESSURE PUMP**

**STAGE 70: ALTERNATOR, PULLEYS AND
RADIATOR HOSE**

**STAGE 71: ENGINE BLOCK, RIGHT EXHAUST
MANIFOLD AND LIGHT SWITCH**

**STAGE 72: LEFT ENGINE BLOCK, EXHAUST
MANIFOLD, GEAR BOX AND RADIATOR
SUPPORT**

**STAGE 73: ENGINE BLOCK BOTTOM,
OIL COOLER AND CONNECTION CABLE**

Stage 65: First Parts of the Radiator

You will begin Pack 9 by starting to assemble the radiator.

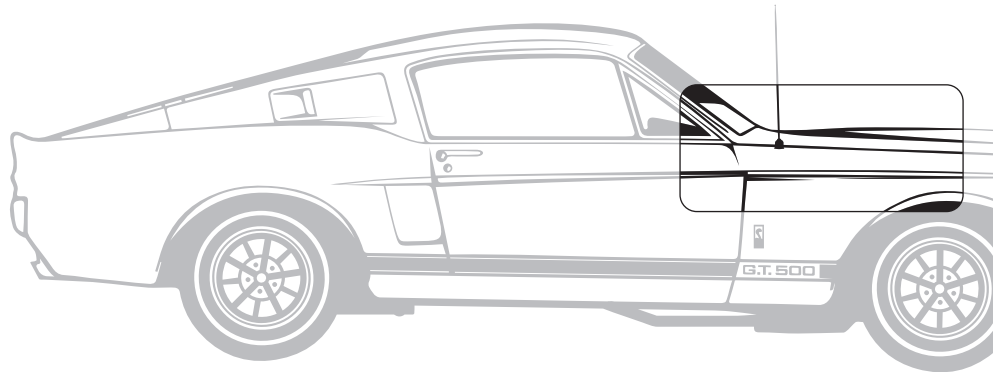

STAGE 65 PARTS LIST

Name	Quantity
Radiator Rear	1
Radiator Rear Grille	1
Fan Bracket	1
Screws TYPE MP01	2 [inc. 1 spare]

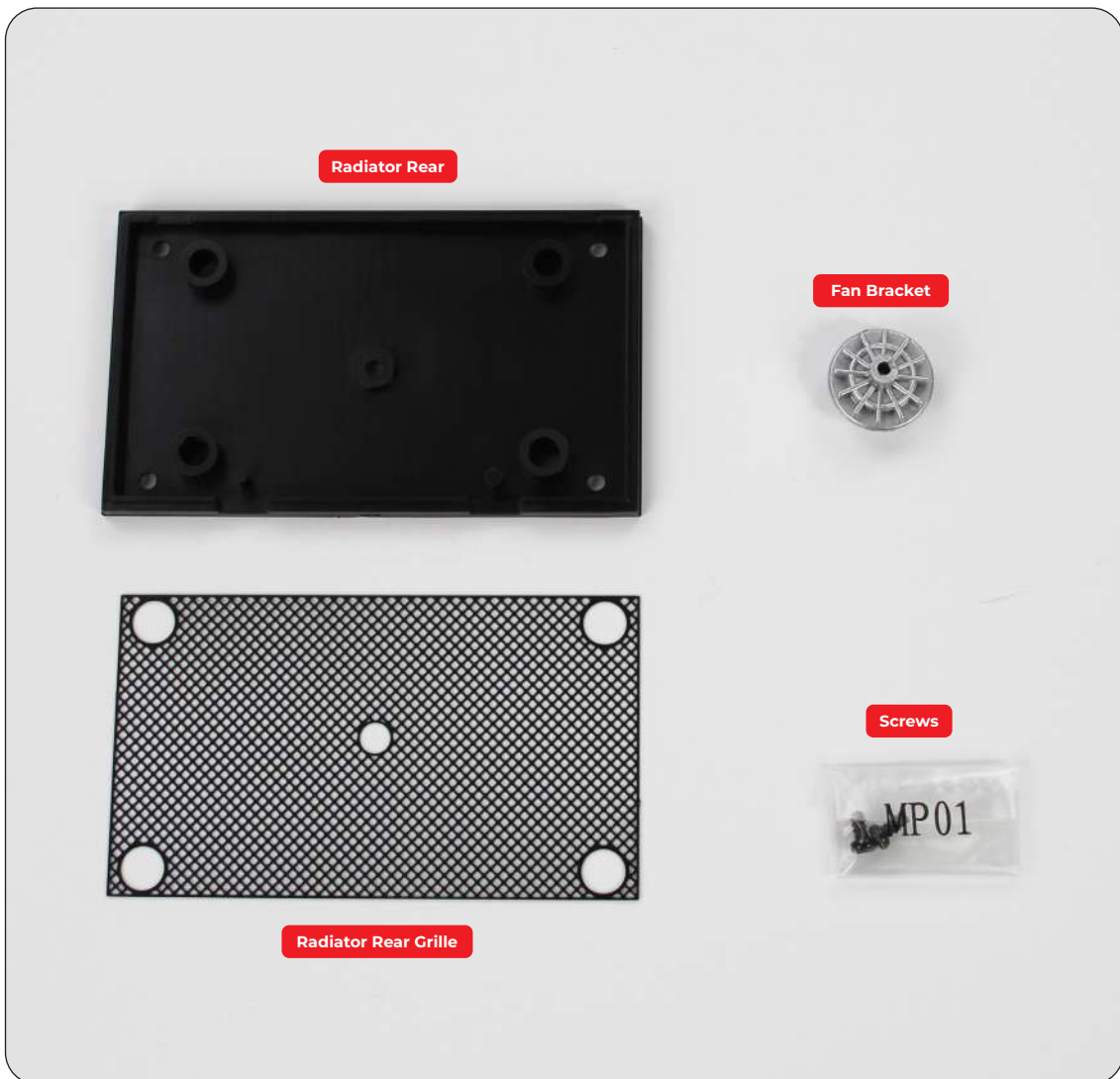

Stage 65: First Parts of the Radiator

STEP 1

ASSEMBLE THE RADIATOR PARTS

Align the flat side of the radiator rear and the radiator rear grille as shown. Place the two pieces together, checking that the centre holes are aligned. If the center hole is not aligned, flip the grille over and try again to get a better fit. Take the fan bracket and note the tiny projection that corresponds with the notch on the radiator. Fit the fan bracket and secure in place from the reverse side with a TYPE MP01 screw.

The radiator will be fitted to the chassis at a later stage. For now, keep the part ready for further

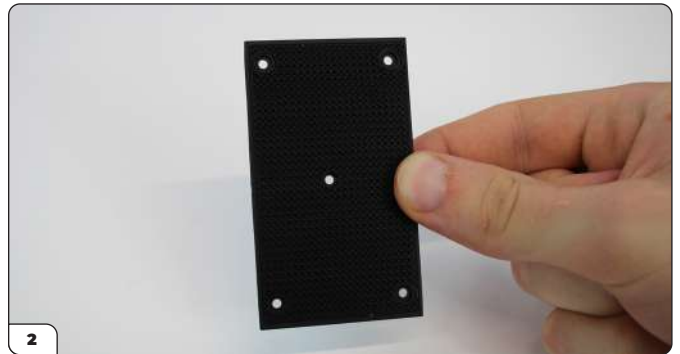
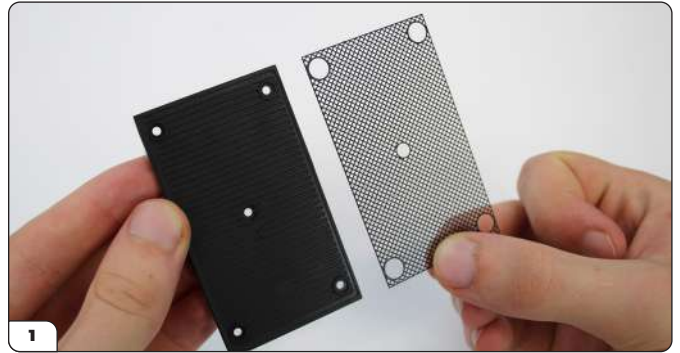

Stage 65: First Parts of the Radiator

Stage 65 complete!



Stage 66: Radiator Shroud and Fan Blade

You will continue to build the radiator.

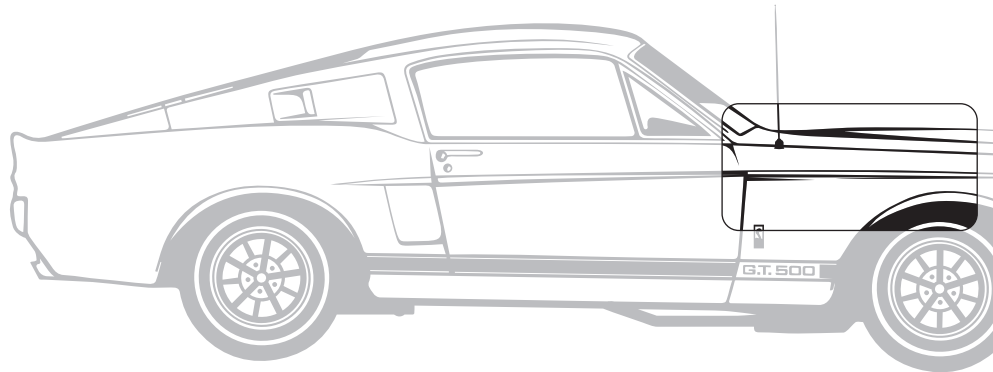

STAGE 66 PARTS LIST

Name	Quantity
Radiator Shroud	1
Fan Blade	1
Screws TYPE MP01	5 [inc. 1 spare]



Stage 66: Radiator Shroud and Fan Blade

STEP 1

ADD THE RADIATOR SHROUD

Take the radiator assembly from stage 65 and align it with the lugs on the radiator shroud as shown. Place the parts together, checking that the corners are fitted correctly. Also check that the fan bracket is in the centre of the radiator shroud. If it looks off centre, rotate the shroud 180 degrees. Fix in place on the reverse side using 4 x TYPE MP01 screws.

The fan blade will be attached in stage 70.

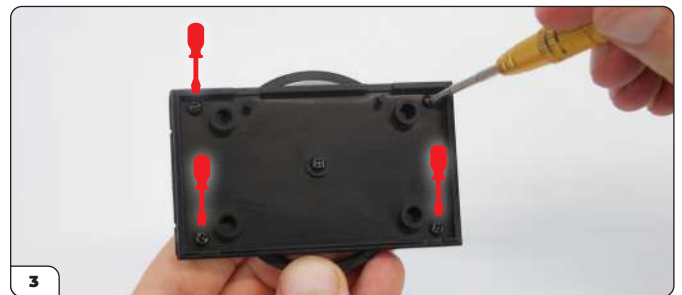
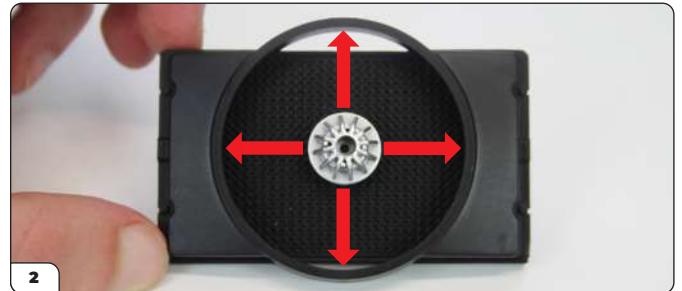
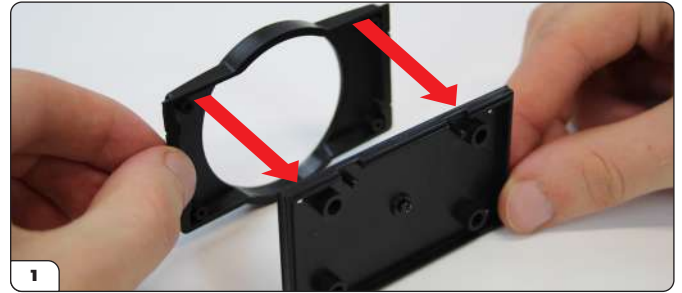

Stage 66 complete!

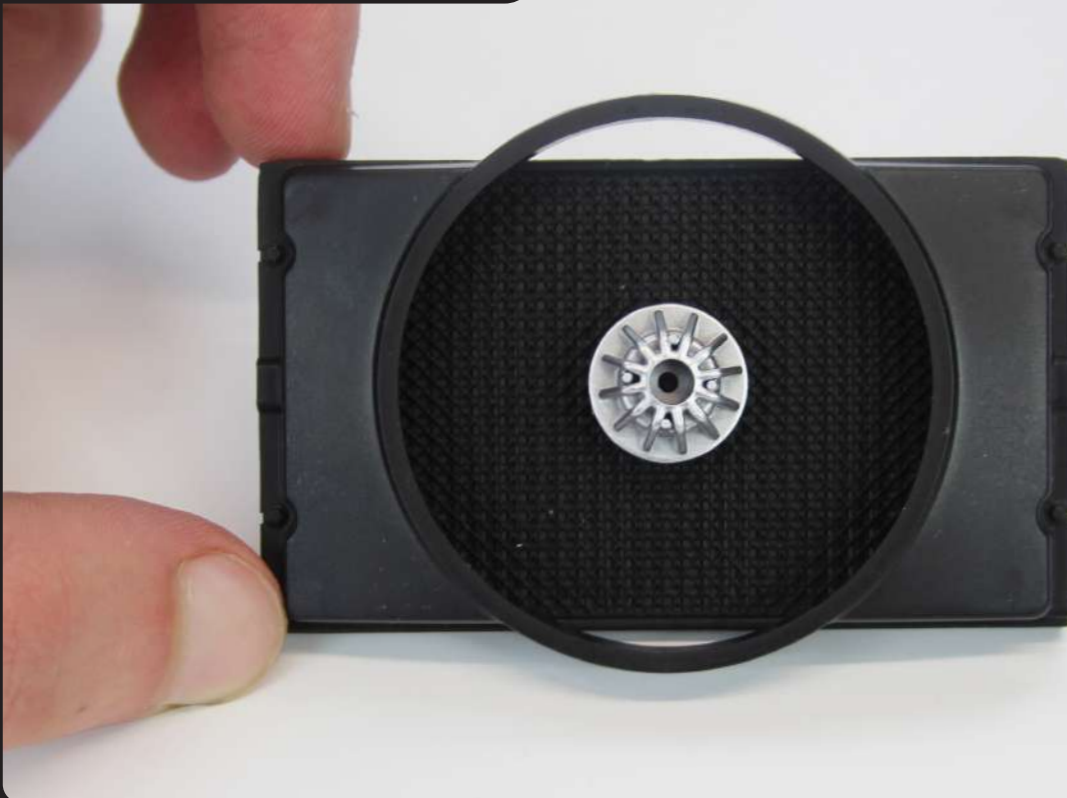

Stage 67: Front of the Radiator

You will continue to add more radiator parts to your assembly.

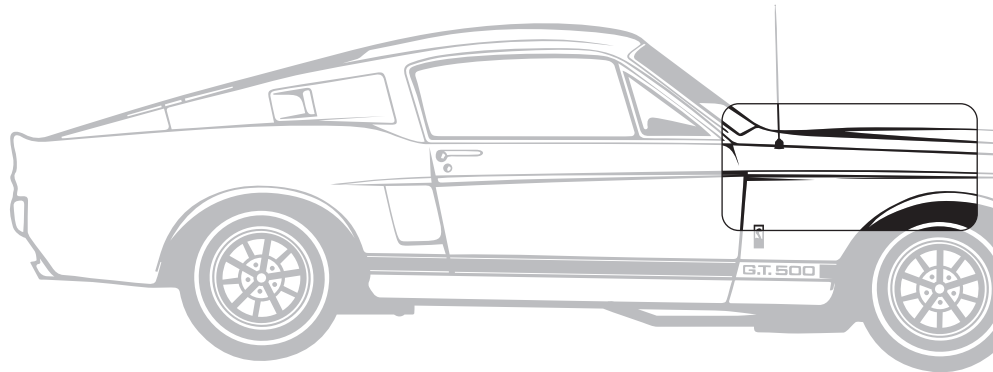

STAGE 67 PARTS LIST

Name	Quantity
Radiator Cap	1
Radiator Top	1
Radiator Front	1
Radiator Grille	1
Screws TYPE MP02	4 [inc. 1 spare]

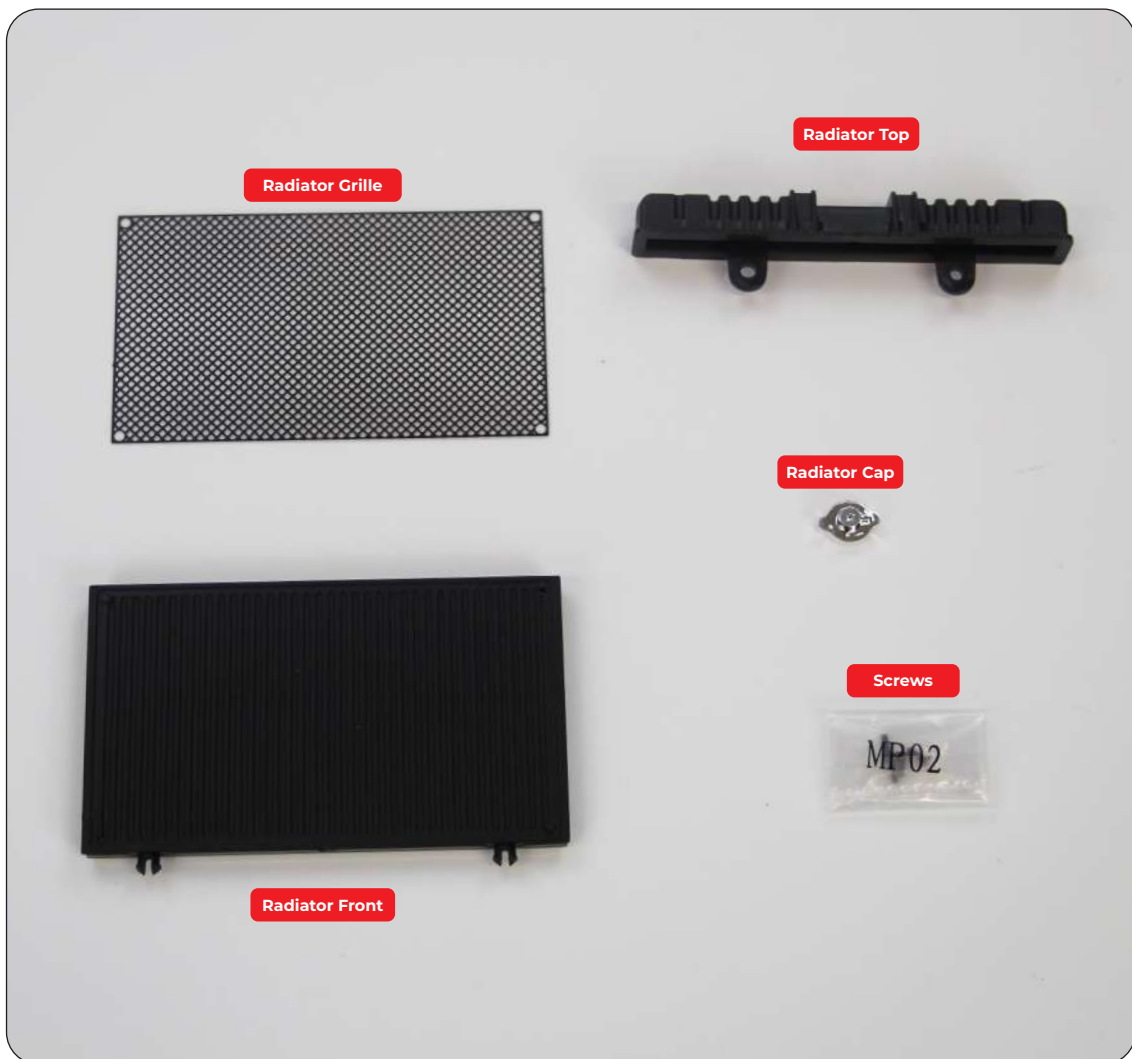

Stage 67: Front of the Radiator

STEP 1

ADD MORE RADIATOR PARTS

Position the radiator cap on the radiator top. There is only one correct position, determined by the little notch shown in picture 1. Secure the cap in place on the reverse side using a TYPE MP02 screw.

Take the radiator assembly from stage 66, holding it with the inside facing up, align the lugs with the holes on the radiator top. Push the lugs into the holes to fix. The radiator top will only fit one way round.

Take the radiator front and align it with the assembly from step 2. Note that the projections on the radiator front face downwards (circled in picture 6). Push the parts together, taking care that the corners fit perfectly together.

Finally, take the radiator grille and place it on top of the radiator front. Fix together using 2 x

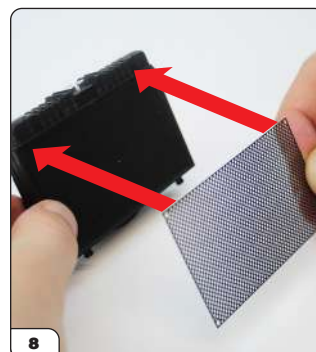
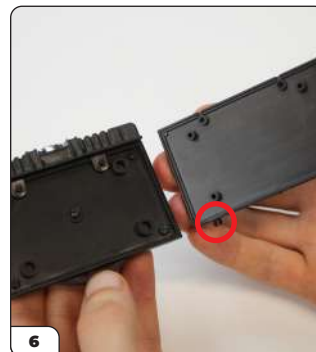
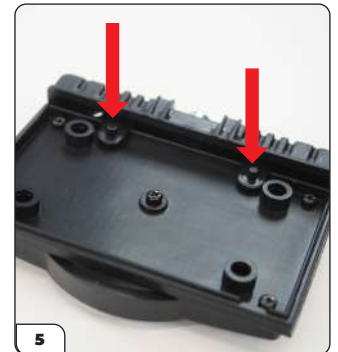
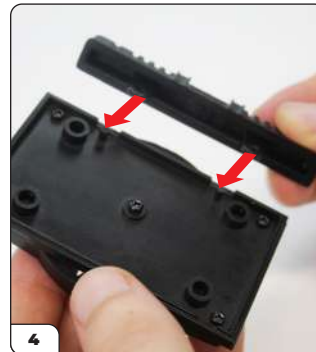
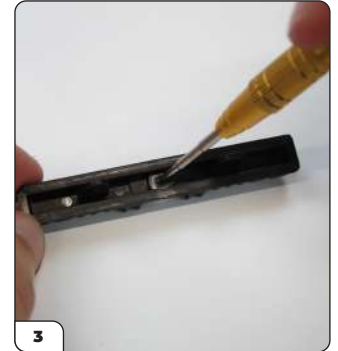

Stage 67: Front of the Radiator

Stage 67 complete!



Stage 68: Engine Parts

You will now start to build the GT40 Mk II 427 engine.

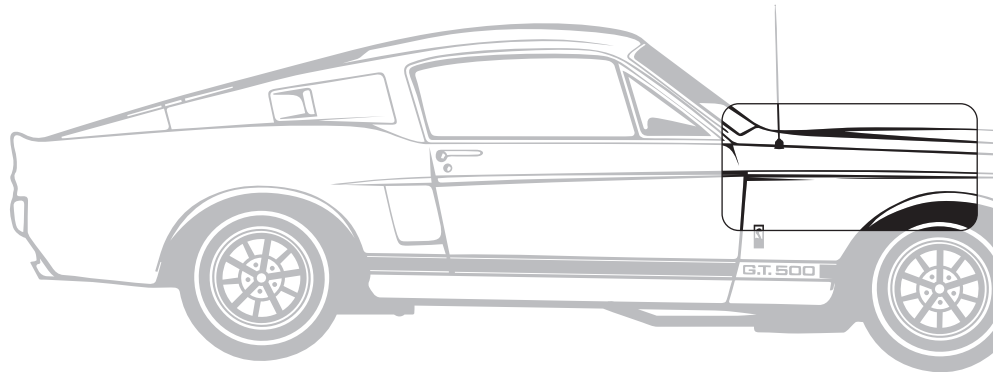

STAGE 68 PARTS LIST

Name	Quantity
Air Filter Bottom	1
Air Filter	1
Air Filter Top	1
Carburetor	1
Left Valve Cover	1
Right Valve Cover	1
Cylinder Head Cover	1
Screws TYPE MD06	5 [inc. 1 spare]
Screws TYPE MP01	7 [inc. 1 spare]



Stage 68: Engine Parts

STEP 1

ASSEMBLE THE AIR FILTER

Take the air filter strip and wrap it around the groove on the air filter bottom. The red strip faces outwards and fits within the groove as shown in picture 2. Tuck in the end and place the air filter top into position to hold the air filter in place (the air filter top only fits one way round). Secure with 2 x TYPE MP01 screws.

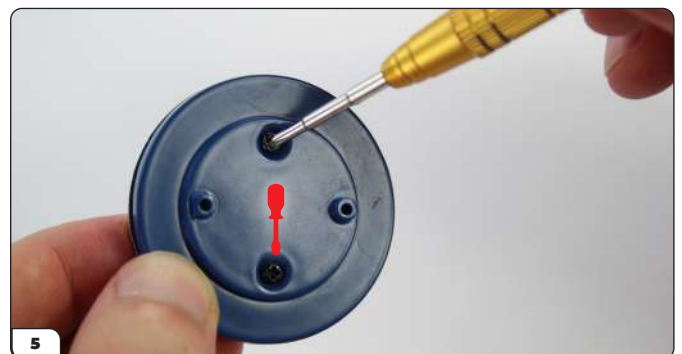
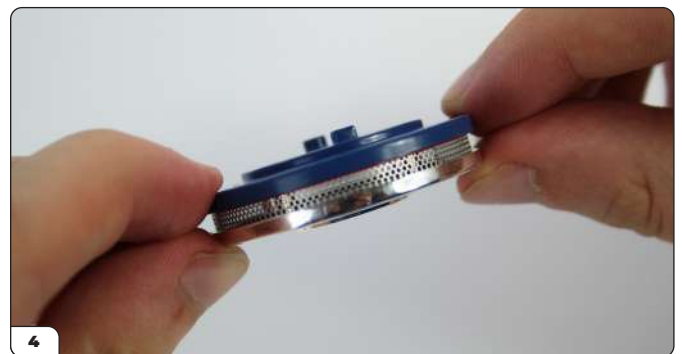
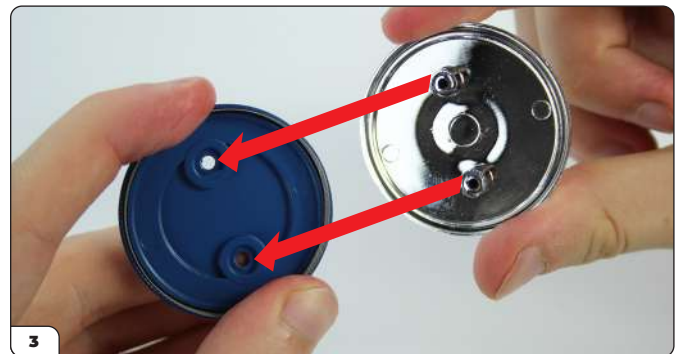
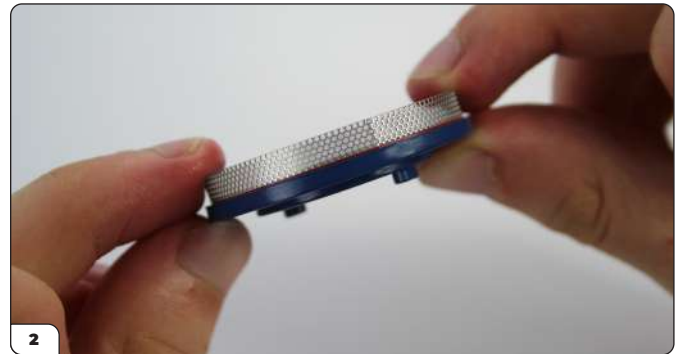

Stage 68: Engine Parts

STEP 2

ATTACH THE CARBURETOR AND CYLINDER HEAD COVER

Align the carburetor with the air filter bottom. Fit together and secure with 2 x TYPE MP01 screws. Fit the cylinder head cover on top of the carburetor and secure with 2 x TYPE MP01 screws.

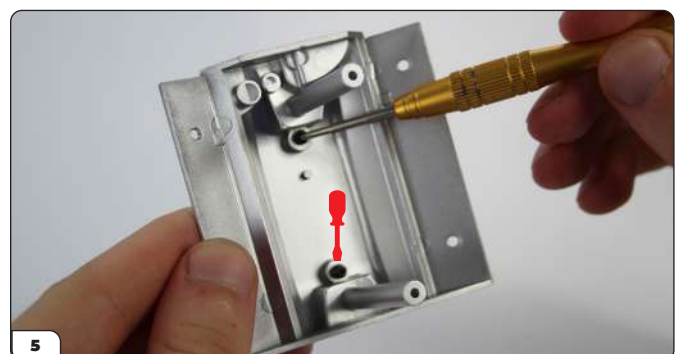
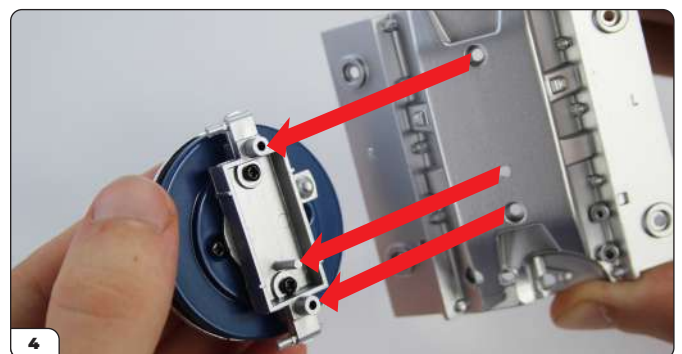
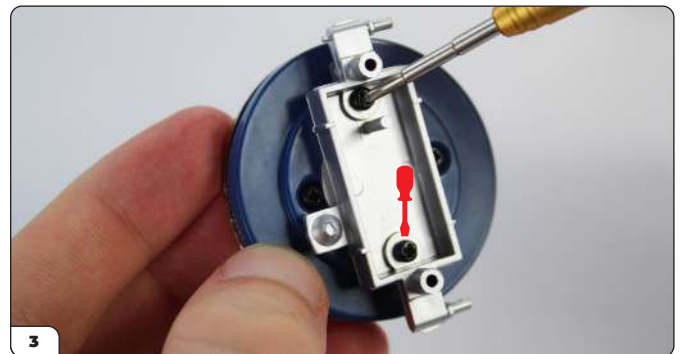
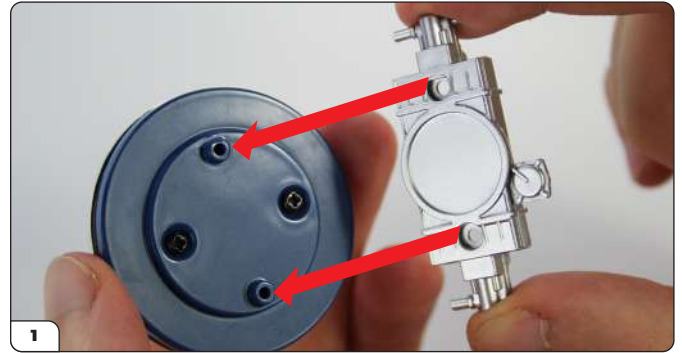

Stage 68: Engine Parts

STEP 3

ATTACH THE VALVE COVERS

Take the cylinder head cover assembly and note that the sides are marked 'L' and 'R'. The left and right valve covers also have corresponding letters marked on the underside. Fit the left valve cover on top of the cylinder head cover on the left side. Fix in place with 2 x TYPE MD06 screws. Repeat to fit the right valve cover on the right side.



ADVICE FROM THE EXPERTS

A drop of oil in the hole will make it easier to drive in the MD06 screws.

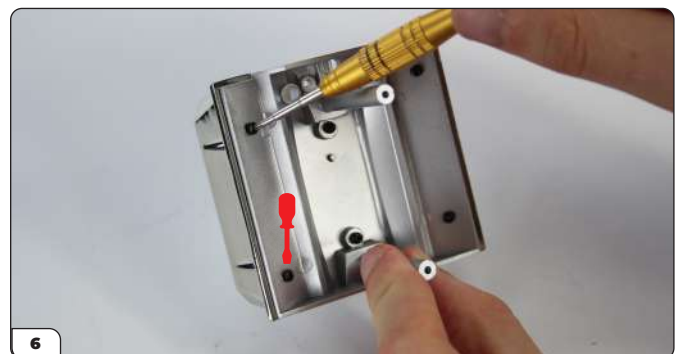
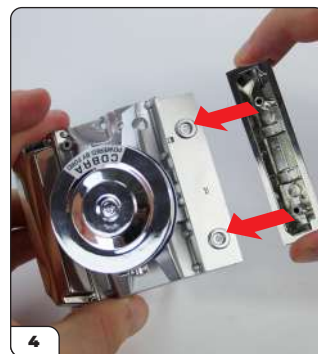
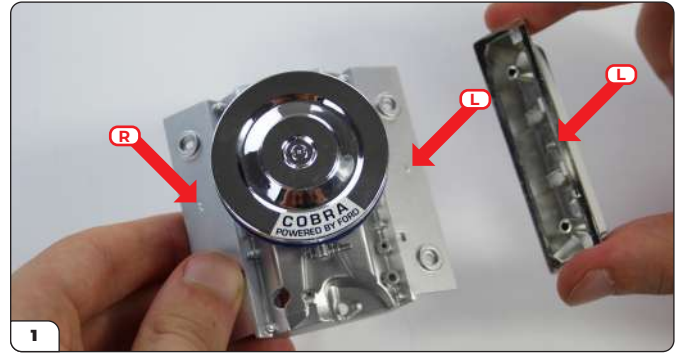

Stage 68: Engine Parts

Stage 68 complete!



Stage 69: Front Housing and Pressure Pump

You will add the front housing and pressure pump to the engine.

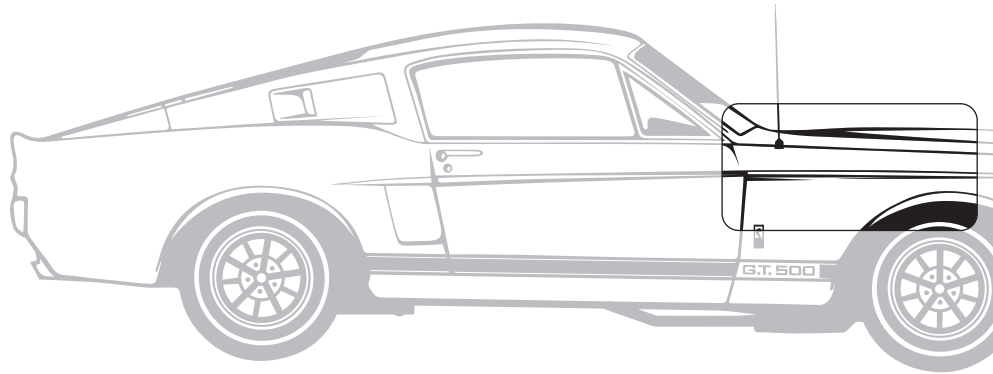

STAGE 69 PARTS LIST

Name	Quantity
Front Housing	1
Front Housing Support	1
Tube	1
Pressure Pump	1
Pressure Pump Support	1
Screws TYPE MD06	3 [inc. 1 spare]
Screws TYPE MP01	2 [inc. 1 spare]



Stage 69: Front Housing and Pressure Pump

STEP 1

ATTACH THE FRONT HOUSING SUPPORT TO THE ENGINE-FRONT HOUSING

Take the front housing support and align the screw holes with the front housing. Note: the protruding screw hole on the support should face the front housing. Secure the parts together using 2 x TYPE MD06 screws. Next, take the small tube and push it into the tiny hole on the front housing. The small tube has two bushes that go to the top. There is a flat on the peg to ensure that these are orientated properly.

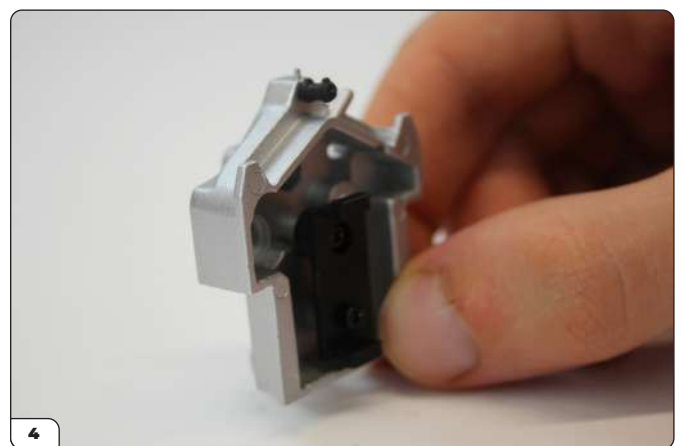
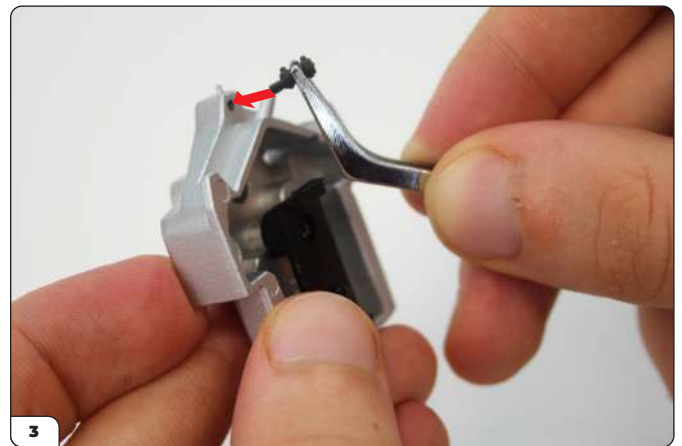
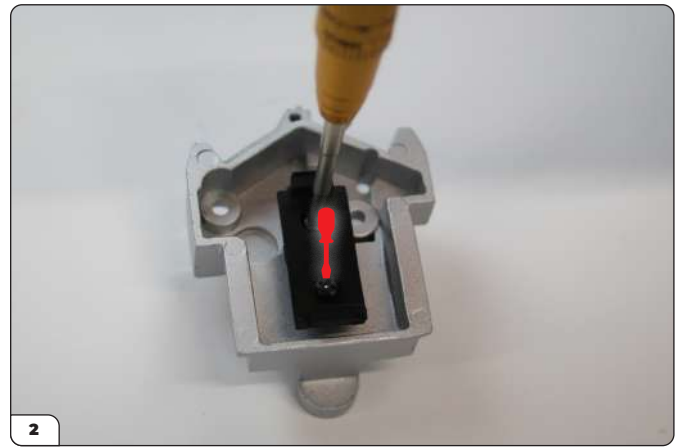
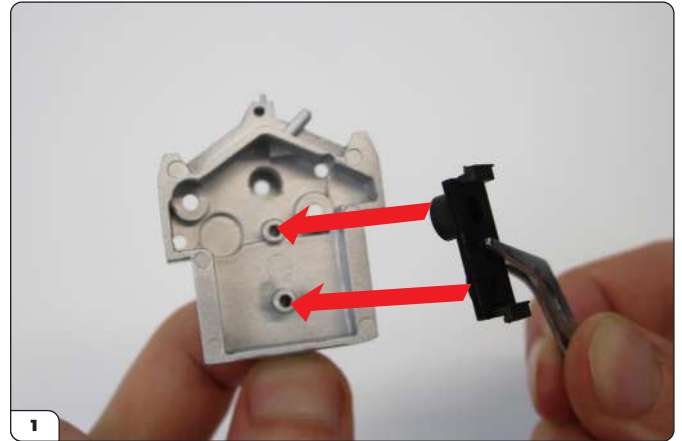

Stage 69: Front Housing and Pressure Pump

STEP 2

ATTACH THE PRESSURE PUMP TO THE ENGINE-FRONT HOUSING

Take the pressure pump and push it onto the pressure pump support. Note, the position of the parts is determined by a 'D' shape. Push quite firmly until it clicks into place. Align the lugs on the pressure pump support with the holes on the engine front housing. Fit together and secure in place from the underside with a TYPE MP01 screw.

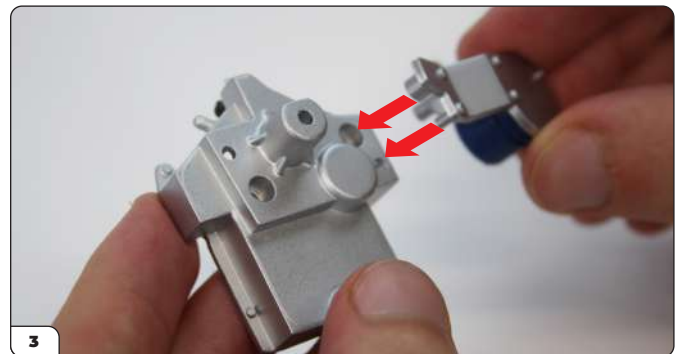

Stage 69: Front Housing and Pressure Pump

Stage 69 complete!

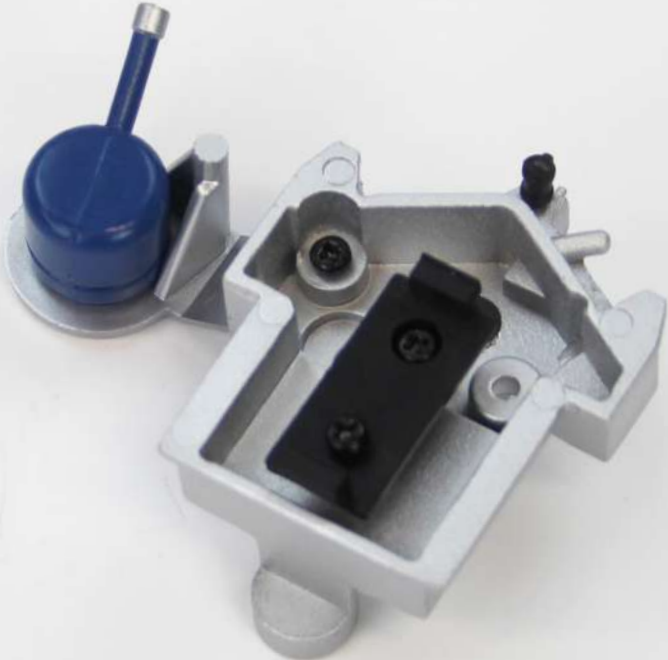

Stage 70: Alternator, Pulleys and Radiator Hose

In this stage you will assemble the alternator, engine pulleys, fan blade and radiator hose.

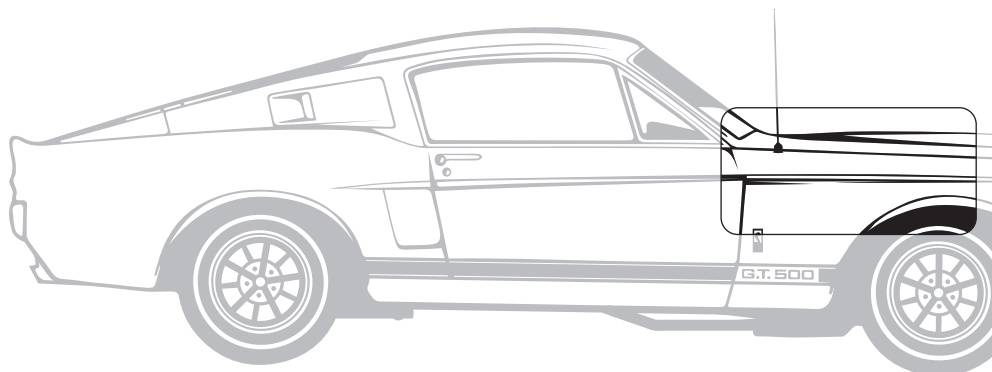

STAGE 70 PARTS LIST

Name	Quantity
Pulleys	1
Radiator Hose part 1	1
Radiator Hose part 2	1
Alternator	1
Alternator Support	1
Screws TYPE MP01	3 [inc. 1 spare]

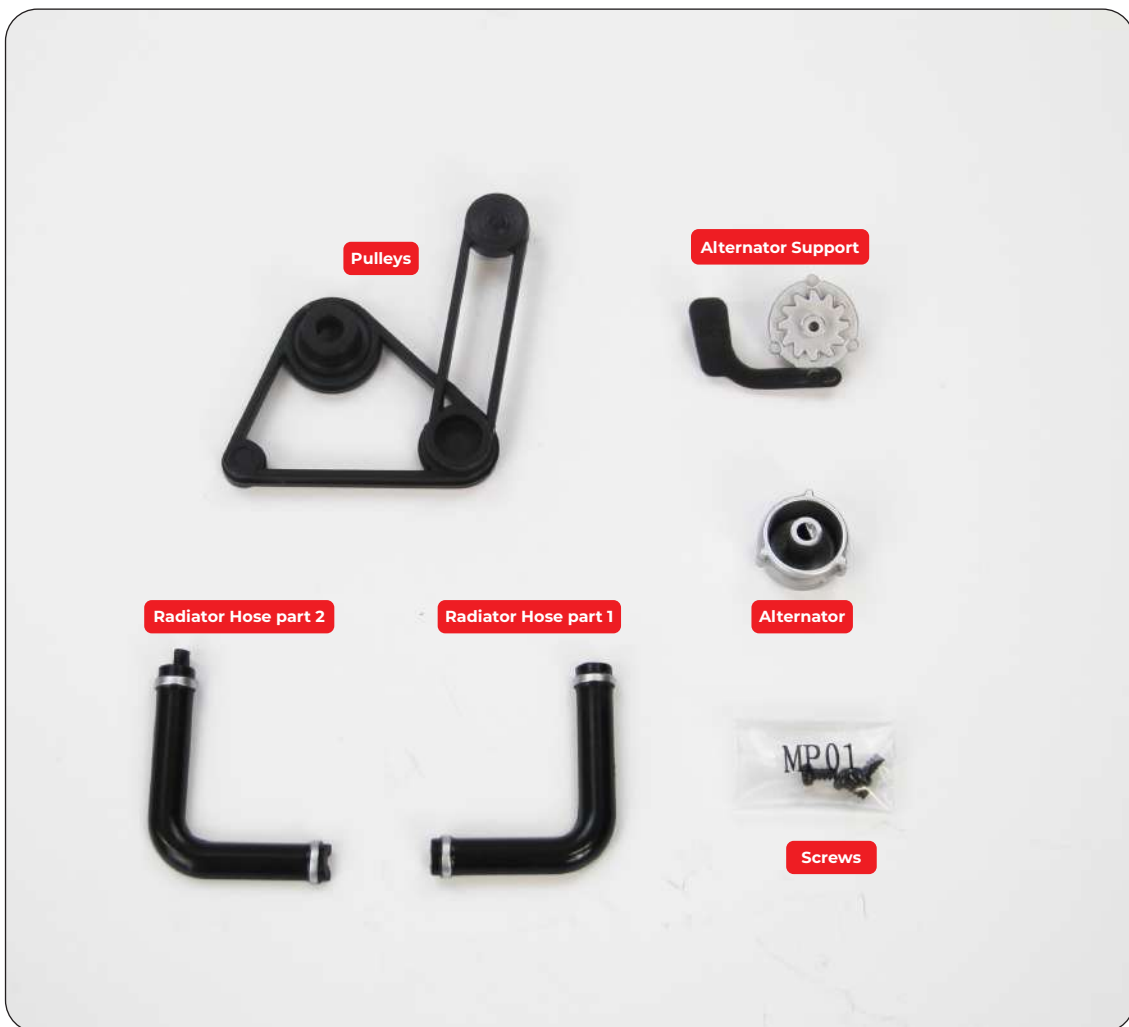

Stage 70: Alternator, Pulleys and Radiator Hose

STEP 1

ASSEMBLE THE ALTERNATOR AND RADIATOR HOSE

Take the alternator and the alternator support and push the pieces firmly together. The correct alignment is determined by a 'D' shape. Assemble the radiator hose by aligning the two halves – part 1 and part 2 – and push them firmly together.

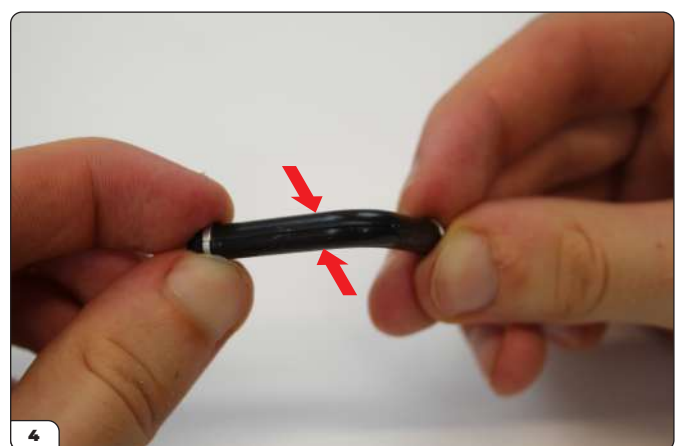
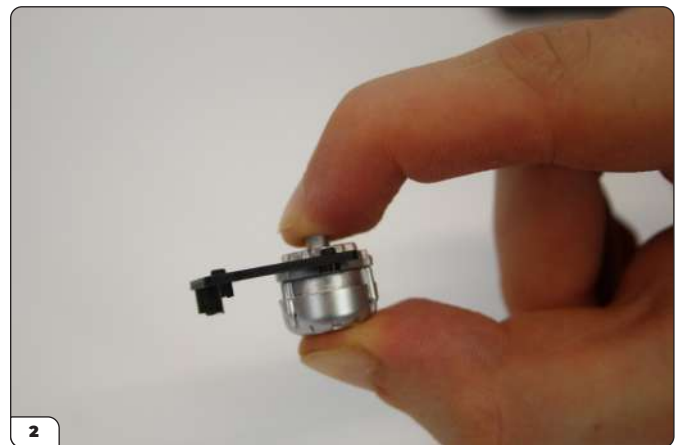
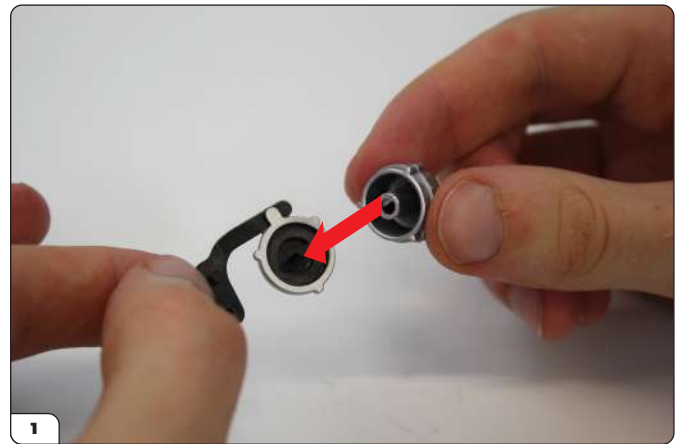

Stage 70: Alternator, Pulleys and Radiator Hose

STEP 2

FIT THE ALTERNATOR TO THE ENGINE FRONT HOUSING

Align the lugs on the alternator assembly with the corresponding holes on the engine casing. Push the parts firmly together and secure on the underside using a TYPE MP01 screw.

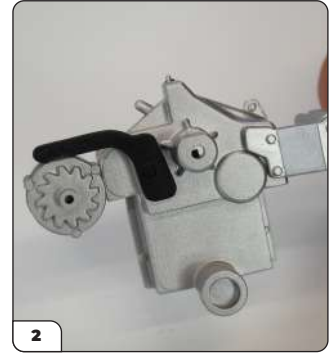
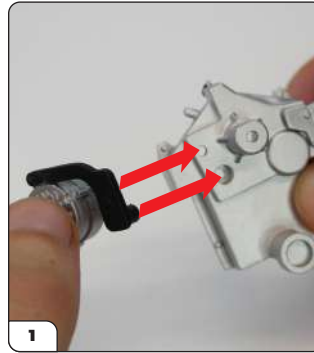

STEP 3

ATTACH THE PULLEYS AND FAN BLADE

Align the engine pulleys over the assembly from step 2. Press firmly to fit the parts together. Then take the fan blade from stage 66 and push this in place on top of the pulleys. **Check that the fan blades lean outwards.** Secure from the reverse side using a TYPE MP01 screw. You should be able to turn the fan blade with just a slight resistance.

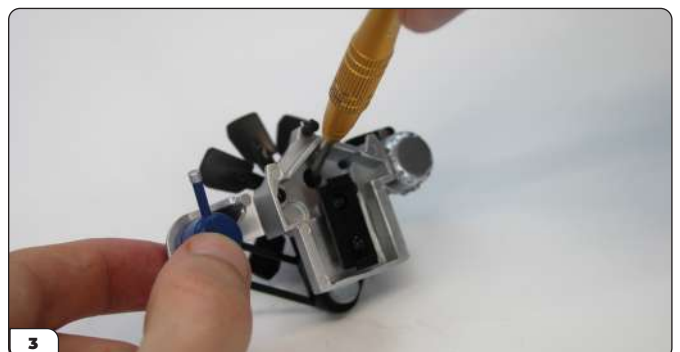
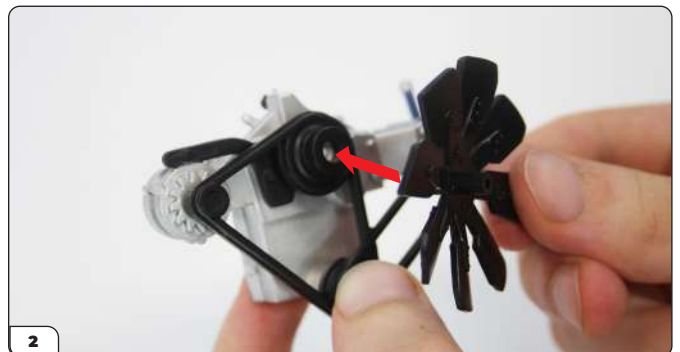
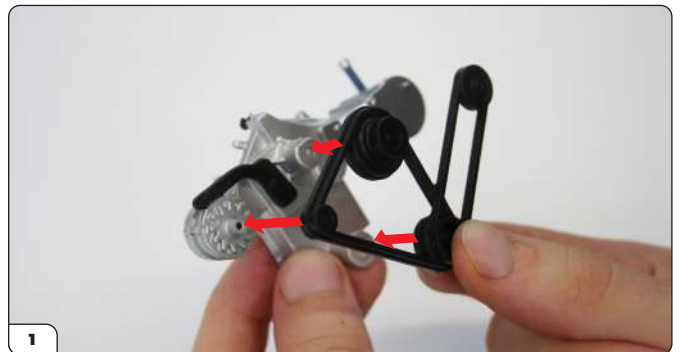

Stage 70: Alternator, Pulleys and Radiator Hose

STEP 4

FIT THE RADIATOR HOSE

Fit the radiator hose to the radiator assembly from stage 67. Align the lug on the pipe with the hole on the radiator assembly and push into position.



Stage 70 complete!



Stage 71: Engine Block, Right Exhaust Manifold and Light Switch

In this stage you will assemble the engine block, right exhaust manifold and light switch

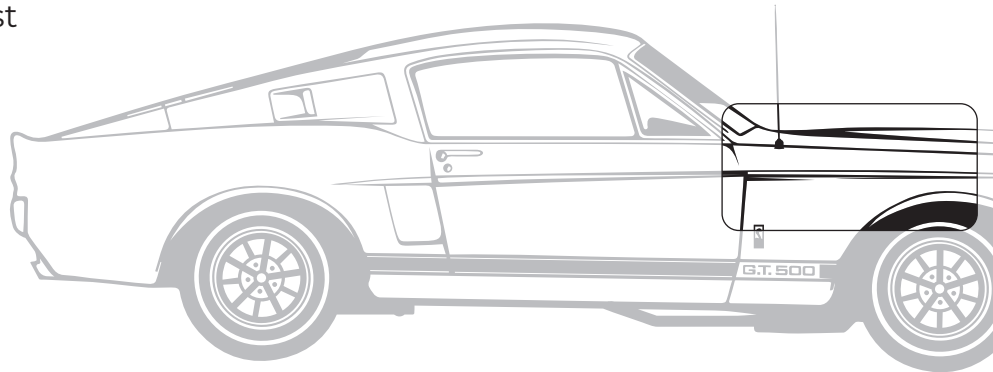

STAGE 71 PARTS LIST

Name	Quantity
Right Engine Block	1
Right Exhaust Manifold Pipe 1	1
Right Exhaust Manifold Pipe 2	1
Right Exhaust Manifold Pipe 3	1
Right Exhaust Manifold Pipe 4	1
Pipe Connector	1
Gas Filter	1
Light Switch	1
Switch Holder	1
Screws Type MP03	3 [including 1 spare]



Stage 71: Engine Block, Right Exhaust Manifold and Light Switch

STEP 1

ATTACH THE GAS FILTER TO THE ENGINE BLOCK

Fit the gas filter to the right engine block. Secure in place using a TYPE MP03 screw.

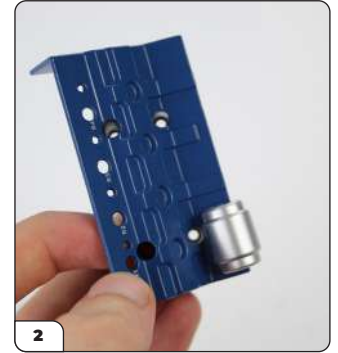
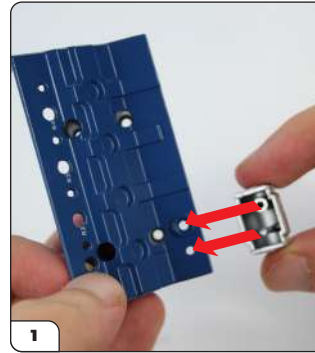

STEP 2

FIT THE LIGHT SWITCH TO THE DASHBOARD

Hold the light switch as shown and insert it into the small hole at the back of the dashboard. Push firmly into position. Hold the switch bracket as shown and push it into the recess next to the switch. The bracket should overlap the switch. Secure in place with a TYPE MP03 screw. Check the operation of the switch by flicking it gently up and down from the front of the dashboard.

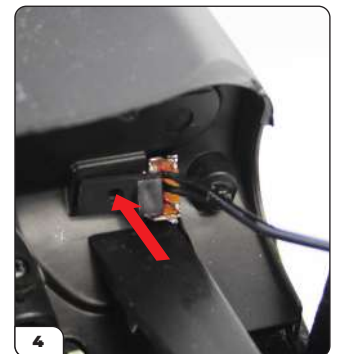
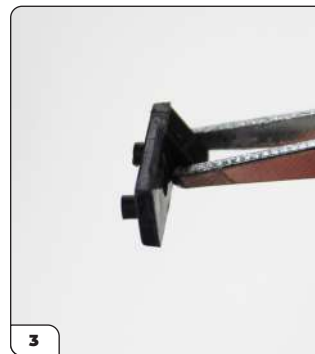

Stage 71: Engine Block, Right Exhaust Manifold and Light Switch

STEP 3

ASSEMBLE THE RIGHT EXHAUST MANIFOLD

Take the pipe connector and note that the holes are numbered 1–4. These numbers correspond to the numbers on each manifold pipe. Carefully but firmly, push each pipe into the corresponding hole. There is only one way to fit the pipes, determined by the 'D' shape of the hole. If the pipe doesn't fit, try rotating it until the fit is correct. You will note that the free ends of each pipe form a straight line.

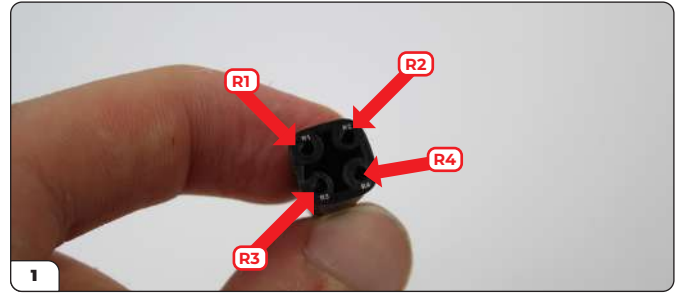

Stage 71 complete!



Stage 72: Left Engine Block, Exhaust Manifold, Gear Box and Radiator Support

In stage 72 you will continue to build the Super Snake engine.

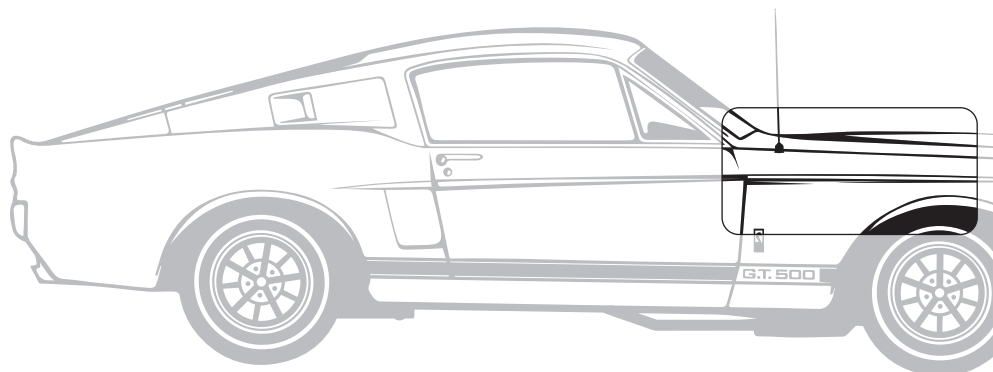

STAGE 72 PARTS LIST

Name	Quantity
Left Engine Block	1
Left Exhaust Manifold Pipe 1	1
Left Exhaust Manifold Pipe 2	1
Left Exhaust Manifold Pipe 3	1
Left Exhaust Manifold Pipe 4	1
Pipe Connector	1
Gear Box (top part)	1
Radiator Support	1
Screws Type MD06	5 [including 1 spare]

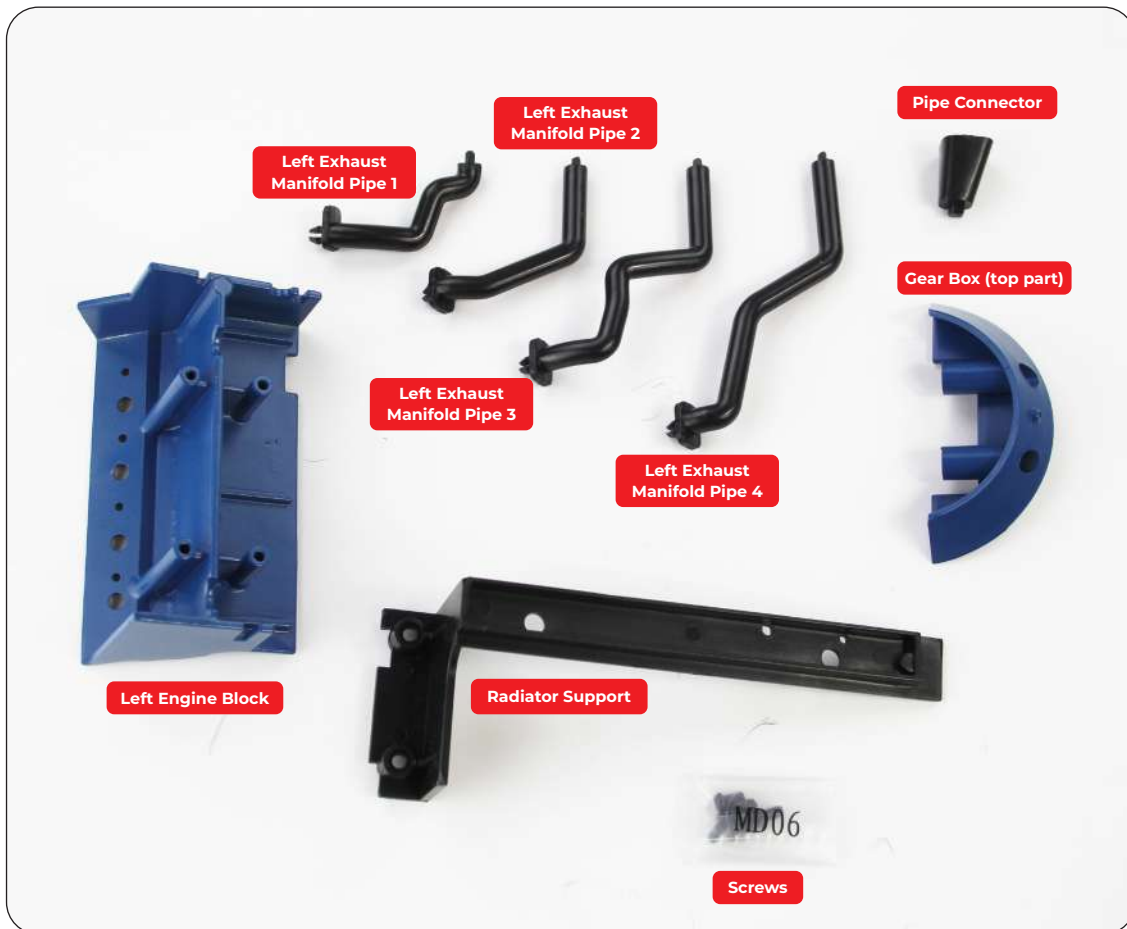

Stage 72: Left Engine Block, Exhaust Manifold, Gear Box and Radiator Support

STEP 1

ASSEMBLE THE LEFT EXHAUST MANIFOLD

Just as you did for the right exhaust manifold, take the pipe connector and note that the holes are numbered 1–4. These numbers correspond with the numbers on each manifold pipe. Carefully but firmly push each pipe into the corresponding hole. There is only one way to fit the pipes, determined by the 'D' shape of the hole. If the pipe doesn't fit, try rotating it until the fit is correct. You will note that the free ends of each pipe form a straight line.

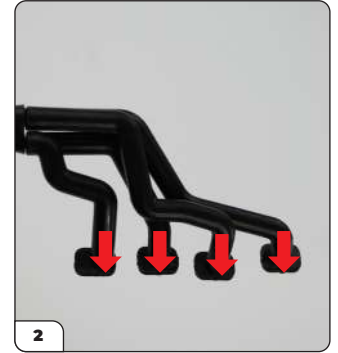
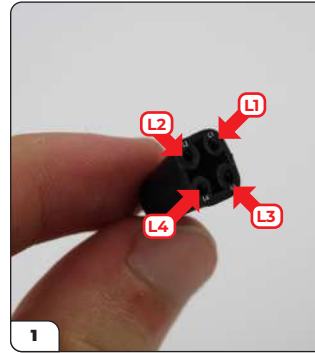

STEP 2

ASSEMBLE THE ENGINE COMPONENTS

Take the left engine block and align the two slots on one end with the anchors on the engine front casing and fan assembly from stage 70. Slide the parts into position by gently wiggling them together. Fit the gearbox part in a similar way, sliding the anchors into the grooves. Next, push and wiggle the right engine block into position as shown. Secure in position using 4 x TYPE MD06 screws.

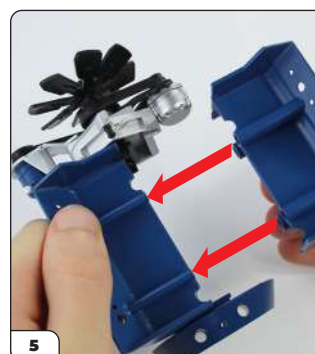
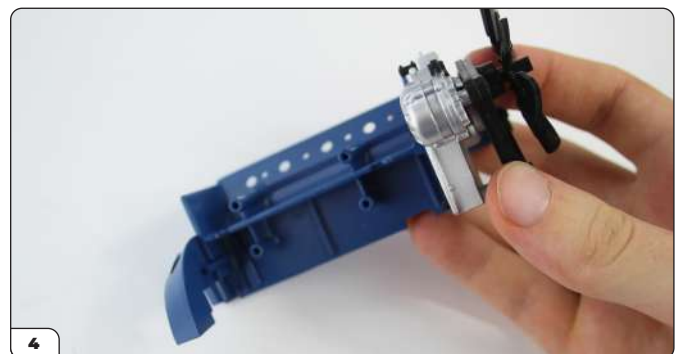
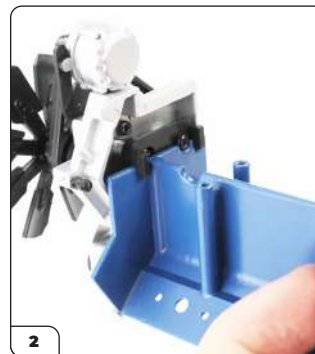
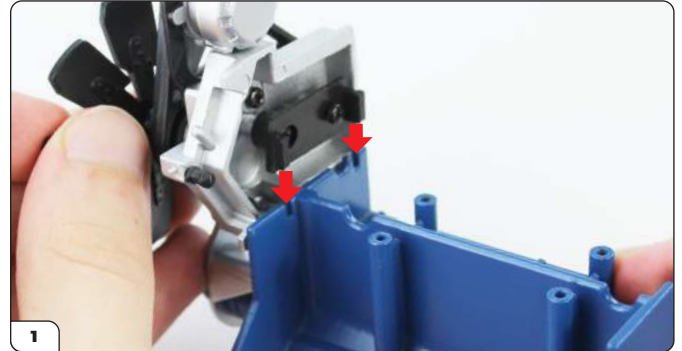

Stage 72: Left Engine Block, Exhaust Manifold, Gear Box and Radiator Support

STEP 3

ATTACH THE LEFT EXHAUST MANIFOLD TO THE LEFT ENGINE BLOCK

Take the left exhaust manifold and push each pipe into the corresponding hole on the left engine block. Repeat this operation to fix the right exhaust manifold on the right side.

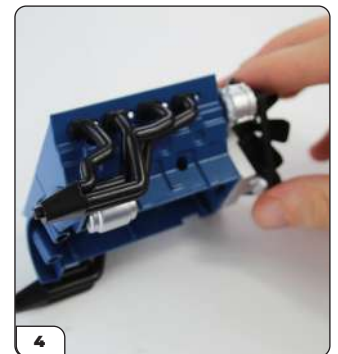
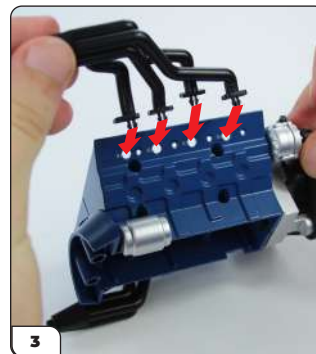
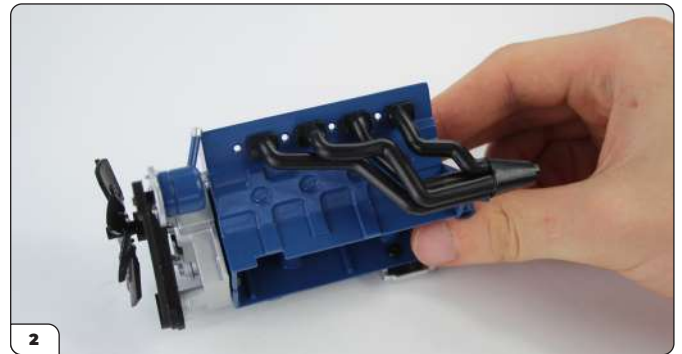

STEP 4

ATTACH THE RADIATOR ASSEMBLY TO THE RADIATOR SUPPORT

Align the radiator assembly from stage 67 with the radiator support. Push the parts together to fix.



Stage 72: Left Engine Block, Exhaust Manifold, Gear Box and Radiator Support

Stage 72 complete!



Stage 73: Engine Block Bottom, Oil Cooler and Connection Cable

You are now going to assemble and fit a few more engine parts.

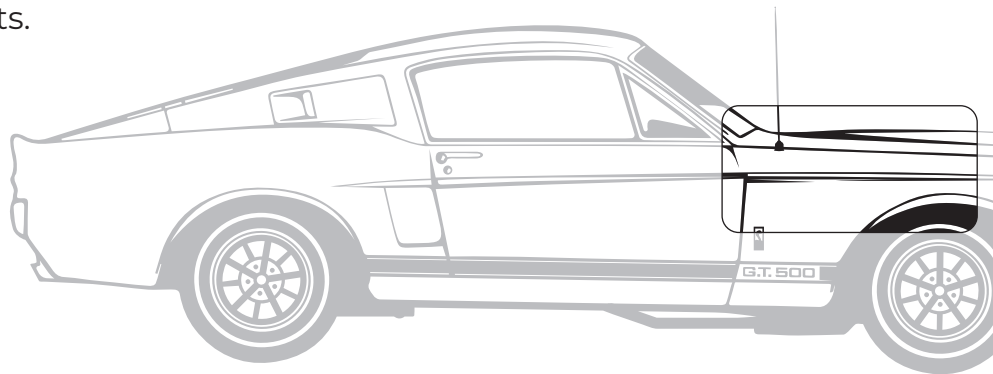

STAGE 73 PARTS LIST

Name	Quantity
Engine Bottom Plate	1
Filler Pipe Cap	1
Pressure Probe	1
Filler Pipe	1
Connection Cable	1
Oil Cooler	1
Oil Cooler Grill	1
Oil Cooler Front	1
Screws TYPE MD08	3 [inc. 1 spare]
Screws TYPE MP07	5 [inc. 1 spare]

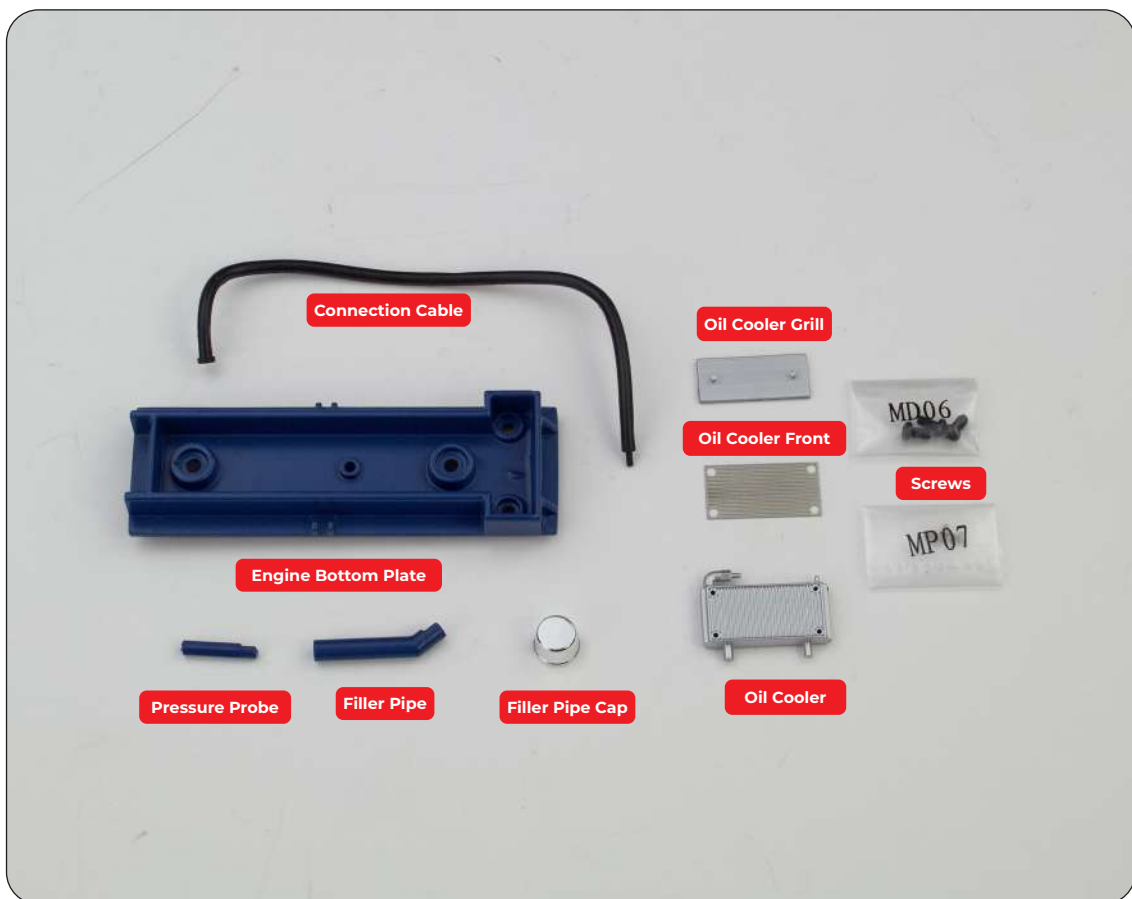

Stage 73: Engine Block Bottom, Oil Cooler and Connection Cable

STEP 1

ADD MORE COMPONENTS TO THE ENGINE

Mount the cylinder head assembly from stage 68 onto the engine block assembly from the previous stage. Turn the assembly over and place the engine bottom plate in place. Secure with 2 x TYPE MD06 screws.



ADVICE FROM THE EXPERTS

Make sure the small pipe fitted in stage 69 is fully seated before fitting the cylinder head assembly.

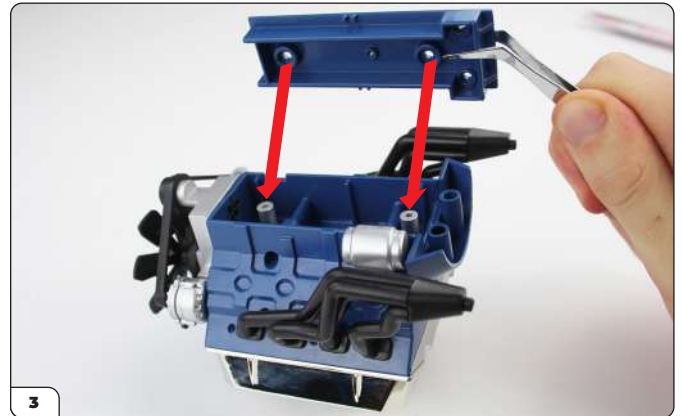
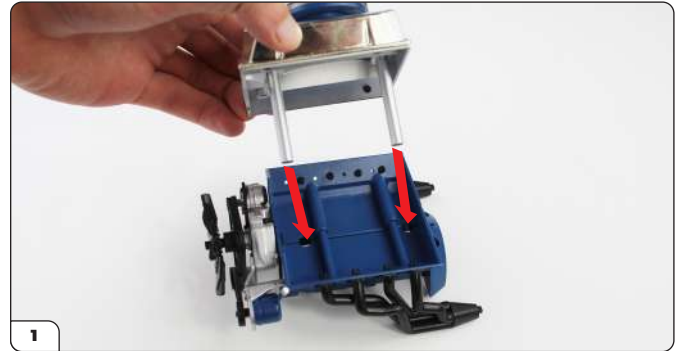

Stage 73: Engine Block Bottom, Oil Cooler and Connection Cable

STEP 2

ADD THE FILLER PIPE, PRESSURE PROBE AND CONNECTION CABLE

Push the filler pipe cap over the end of the filler pipe, then push the free end of the filler pipe into the hole on the cylinder head. Take the pressure probe and push it into its corresponding hole. Place the ends of the connection cable into the holes on the engine block as shown.

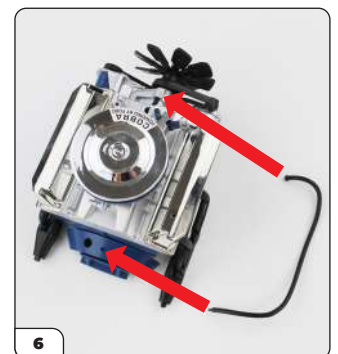

Stage 73: Engine Block Bottom, Oil Cooler and Connection Cable

STEP 3

ASSEMBLE AND ATTACH THE OIL COOLER

Take the oil cooler and push the oil cooler grill into position, then flip the parts over and push the oil cooler front onto the opposite side. Fix the parts together using 4 x TYPE MP07 screws. Align the lugs on the oil cooler with the holes on the radiator from the previous stage. Check that the front is facing outwards and push together to secure in place.

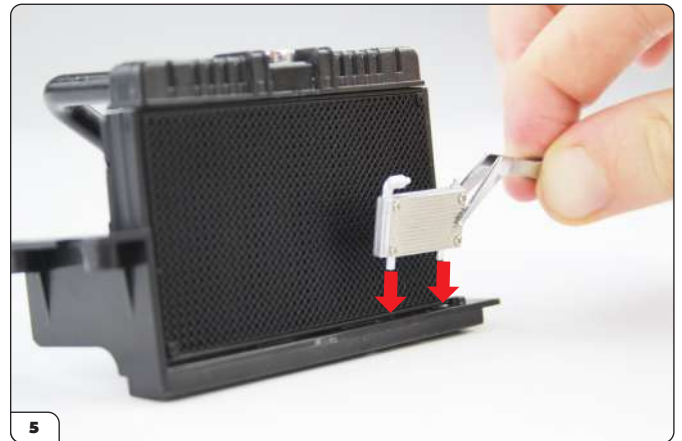
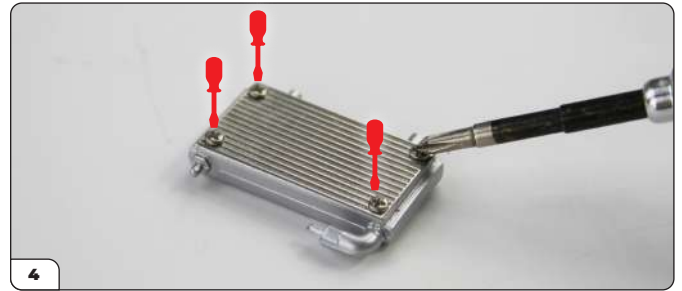
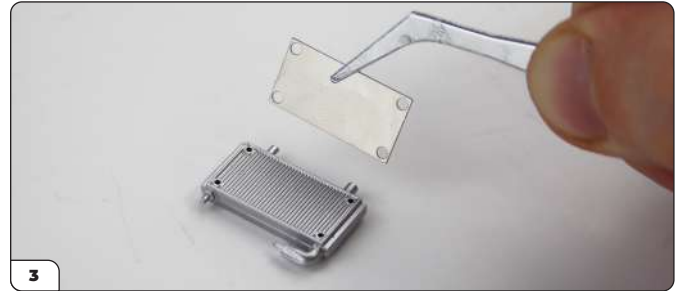

Stage 73: Engine Block Bottom, Oil Cooler and Connection Cable

Stage 73 complete!

